

DOLLAR GENERAL

PROJECT:
 HANEX DEVELOPMENT
 DOLLAR GENERAL AND
 FUTURE MINI STORAGE,
 ZEPHYRHILLS, FL

ALDS
 CIVIL ENGINEERING
 1000 EAST BAYVIEW BL
 SUITE 100
 TAMPA, FL 33604
 P: (813) 988-4222
 F: (813) 988-4223
 WWW.ALDSINC.COM

NO.	DATE	REVISION / ISSUE

DESIGNER'S NAME & PID#

PREPARED BY:
 LANDMARK CONSULTANTS, LLC
 P. E. LUCAS, PE, LEED AP
 1000 EAST BAYVIEW BL, SUITE 100
 TAMPA, FL 33604
PROJECT # 28,420
SHEET 28,420
DATE 12/01/09
SCALE 1:20

EASEMENT PLAN
CO. 2

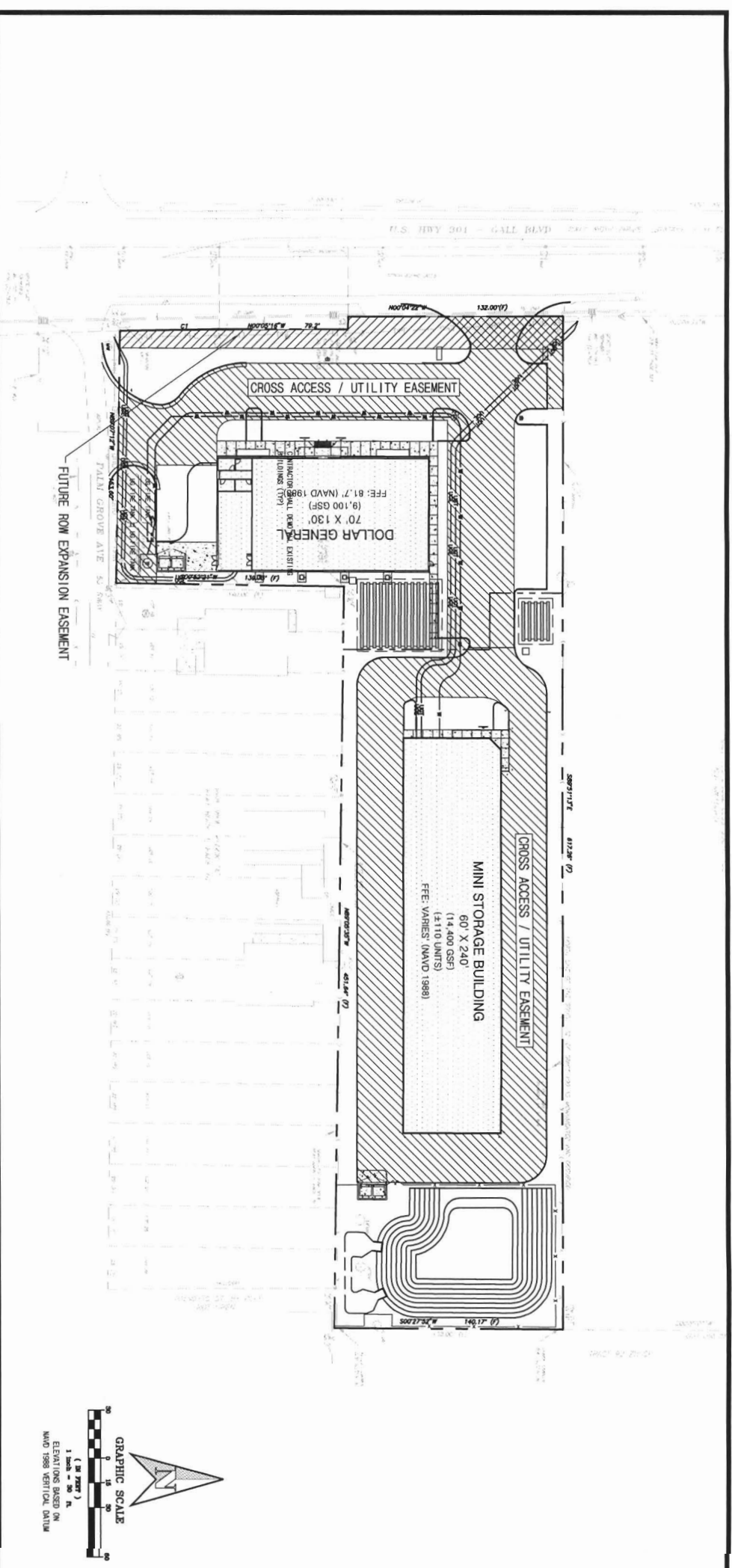

CONTRACTOR NOTES:

1. LOCATIONS, ELEVATIONS, AND DIMENSIONS OF EXISTING UTILITIES, STRUCTURES AND OTHER FEATURES ARE SHOWN ACCORDING TO THE BEST INFORMATION AVAILABLE AT THE TIME OF PREPARATION OF THESE PLANS. THE CONTRACTOR SHALL VERIFY THE LOCATION, ELEVATION, AND DIMENSIONS OF ALL EXISTING UTILITIES, STRUCTURES AND OTHER FEATURES BEFORE BEGINNING CONSTRUCTION. ANY DISCREPANCIES SHOULD BE IMMEDIATELY REPORTED TO THE ENGINEER. NO FIELD CORRECTIONS ARE TO BE MADE WITHOUT THE WRITTEN APPROVAL OF THE ENGINEER.
2. PRIOR TO THE INITIATION OF SITE CONSTRUCTION, THE CONTRACTOR SHALL VERIFY ANY EXISTING UTILITIES INCLUDING GAS, WATER, ELECTRIC, COMMUNICATIONS, CABLE TV, SANITARY AND STORM SEWERS, OR ANY OTHER UTILITIES TO THE SITE, REMOVE OR CAP AS NECESSARY.
3. THE CONTRACTOR SHALL EXERCISE EXTREME CAUTION IN AREAS OF BURIED UTILITIES AND SHALL CALL "STAKEOUT" AT 1-800-482-4276, AT LEAST 48 HOURS PRIOR TO CONSTRUCTION, TO ARRANGE FOR FIELD LOCATIONS OF BURIED UTILITIES.
4. THE CONTRACTOR IS RESPONSIBLE FOR REPAIRING ANY DAMAGE TO EXISTING FACILITIES, ABOVE OR BELOW GROUND, THAT MAY OCCUR AS A RESULT OF THE WORK PERFORMED, BY THE CONTRACTOR OR SUBCONTRACTORS, AS CALLED FOR IN THESE CONTRACT DOCUMENTS.
5. IT IS THE CONTRACTOR'S RESPONSIBILITY TO SECURE PERMITS WITH THE PERMIT INSPECTION AND CERTIFICATION REQUIREMENTS OF THE STATE OF FLORIDA. THE CONTRACTOR SHALL OBTAIN ALL NECESSARY PERMITS PRIOR TO CONSTRUCTION, AND OBTAIN INSPECTIONS ACCORDING TO ADOPTED INSTRUCTIONS/REQUIREMENTS.
6. THE GRAPHIC INFORMATION DEPICTED ON THESE PLANS HAS BEEN COMPILED TO PROPORTION BY SCALE AS ACCURATELY AS POSSIBLE. SCALE FOR CONSTRUCTION PURPOSES.
7. ALL SPECIFICATIONS AND DOCUMENTS REFERENCED HEREIN SHALL BE OF THE LATEST REVISION.
8. WORK PERFORMED UNDER THIS CONTRACT SHALL INTERFERE SMOOTHLY WITH ANY OTHER WORK BEING PERFORMED ON-SITE BY OTHER CONTRACTORS/SUBCONTRACTORS AND UTILITY COMPANIES. IT WILL BE NECESSARY FOR THE GENERAL CONTRACTOR TO COORDINATE AND SCHEDULE ITS ACTIVITIES ACCORDINGLY.