

RECEIVED  
 FEB 05 2010  
 Zoning NPR

WAL-MART-HUDSON, FL  
 STORE NO. 5266-00, NSC  
 PASCO COUNTY  
 FLORIDA

DATE: 03/14/2008  
 PROJECT NO: 047253294  
 SHEET NUMBER: C6A

KEY SHEET

SCALE: AS NOTED  
 DESIGN ENGINEER: DAVID W. WALTHALL, P.E.  
 DESIGNED BY: KR  
 DRAWN BY: DP  
 CHECKED BY: DWM  
 DATE: 12/14/09

© 2009 KIMLEY-HORN AND ASSOCIATES, INC.  
 10117 PRINCESS PALM AVENUE, SUITE 300, TAMPA, FL 33610  
 WWW.KIMLEY-HORN.COM CA 00006966  
**Kimley-Horn and Associates, Inc.**

No.	REVISIONS	DATE	BY
13	158, 16, AND 17		
12	DC REVISIONS (4, 7, 8A, 9, 10A, 10B, 11, 12)	9/11/09	KRF
11	PASCO COUNTY COMMENTS (SHEET C16, C20)	9/11/09	KRF
10	PASCO COUNTY COMMENTS (SHEET C9 - C11, C16)	1/21/09	DP
9	C9-C10A, C12, C15-C17, C19	5/20/08	DP
8	PASCO COUNTY COMMENTS (SHEETS C1, C5A-C7)	5/20/08	DP

MATCH LINE - STA. 59+00.00 (SEE SHEET C6B)

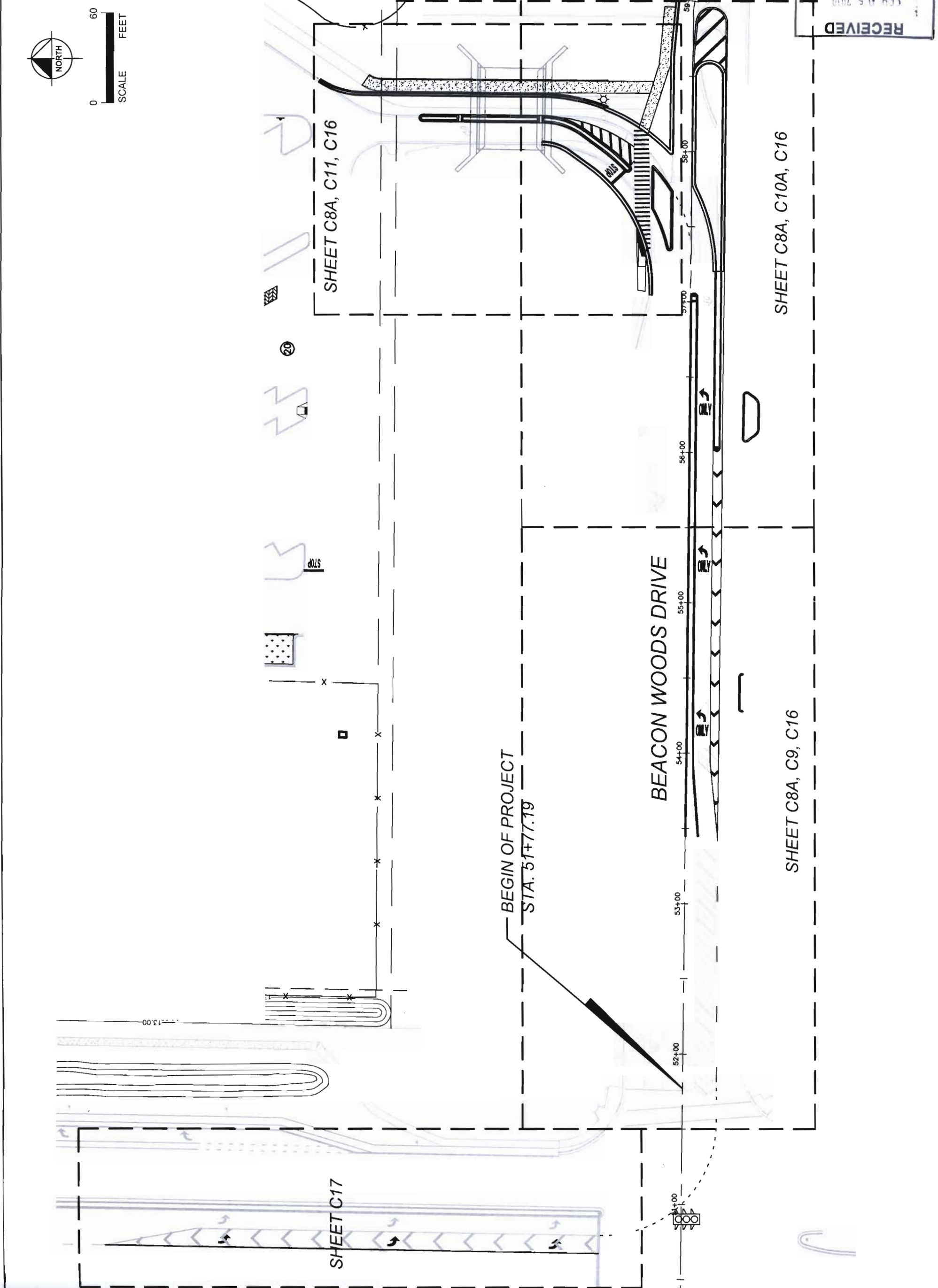

Drawing name: K:\TAM\Civil\047253294 - New Port Richey (NW)\Construction\CONSTRUCTION PLANS\FINAL PLANS\_3\BEACON WOODS AS-BUILT\06A-key sheet.dwg TOPO SURVEY Sep 10, 2009 9:15am by: ken.Maldonado  
 This document, together with the concepts and designs presented herein, as an instrument of service, is intended only for the specific purpose and client for which it was prepared. Reuse of and improper reliance on this document without written authorization and adoption by Kimley-Horn and Associates, Inc. shall be without liability to Kimley-Horn and Associates, Inc.

DATE	BY	REVISIONS
5/20/08	DP	PASCO COUNTY COMMENTS (SHEETS C1, C5A-C7)
1/21/09	DP	C9-C10A, C12, C15-C17, C19
9/11/09	KRF	PASCO COUNTY COMMENTS (SHEET C9 - C11, C16)
9/11/09	KRF	PASCO COUNTY COMMENTS (SHEET C16, C20)
9/11/09	KRF	OC REVISIONS (4, 7, 8A, 9, 10A, 10B, 11, 12)
		13 - 15B, 16, AND 17)

10117 PRINCE PALM AVENUE, SUITE 300, TAMPA, FL 33610  
 WWW.KIMLEY-HORN.COM CA 00000696  
 © 2009 KIMLEY-HORN AND ASSOCIATES, INC.  
**Kimley-Horn and Associates, Inc.**

DESIGN ENGINEER: DAVID W. WALTHALL, P.E.  
 AS NOTED  
 DESIGNED BY: KRT  
 FLORIDA REGISTERED PROFESSIONAL ENGINEER: 62530  
 DRAWN BY: DP  
 CHECKED BY: DWM  
 DATE: 03/14/2008

**KEY SHEET**

WAL-MART-HUDSON, FL  
 STORE NO. 5266-00, NSC  
 PASCO COUNTY  
 FLORIDA

DATE: 03/14/2008  
 PROJECT NO.: 047253294  
 SHEET NUMBER: **C6B**

