

PARKING CALCULATIONS			
Description	SF	SF/Space	Required
Main - Retail	69,531	300	232
Main - Restaurant	10,050	100	101
SW - Office/Retail	7,326	300	24
SW - Restaurant	1,283	100	13
SE - Office/Retail	12,925	300	43
Waffle House - Restaurant	1,610	100	16
Burger King - Restaurant	3,533	100	35
Future Outparcel (N) - Future	9,211	100	92
Future Outparcel (S) - Future	5,887	100	59
Total	122,783		615

DESCRIPTION	WXD (FT)	RETAIL	
		REQUIRED	PROVIDED
Standard	9X20	583	497
Compact	8X18	0	0
Handicap	12X20	22	40
TOTAL	N/A	615	537

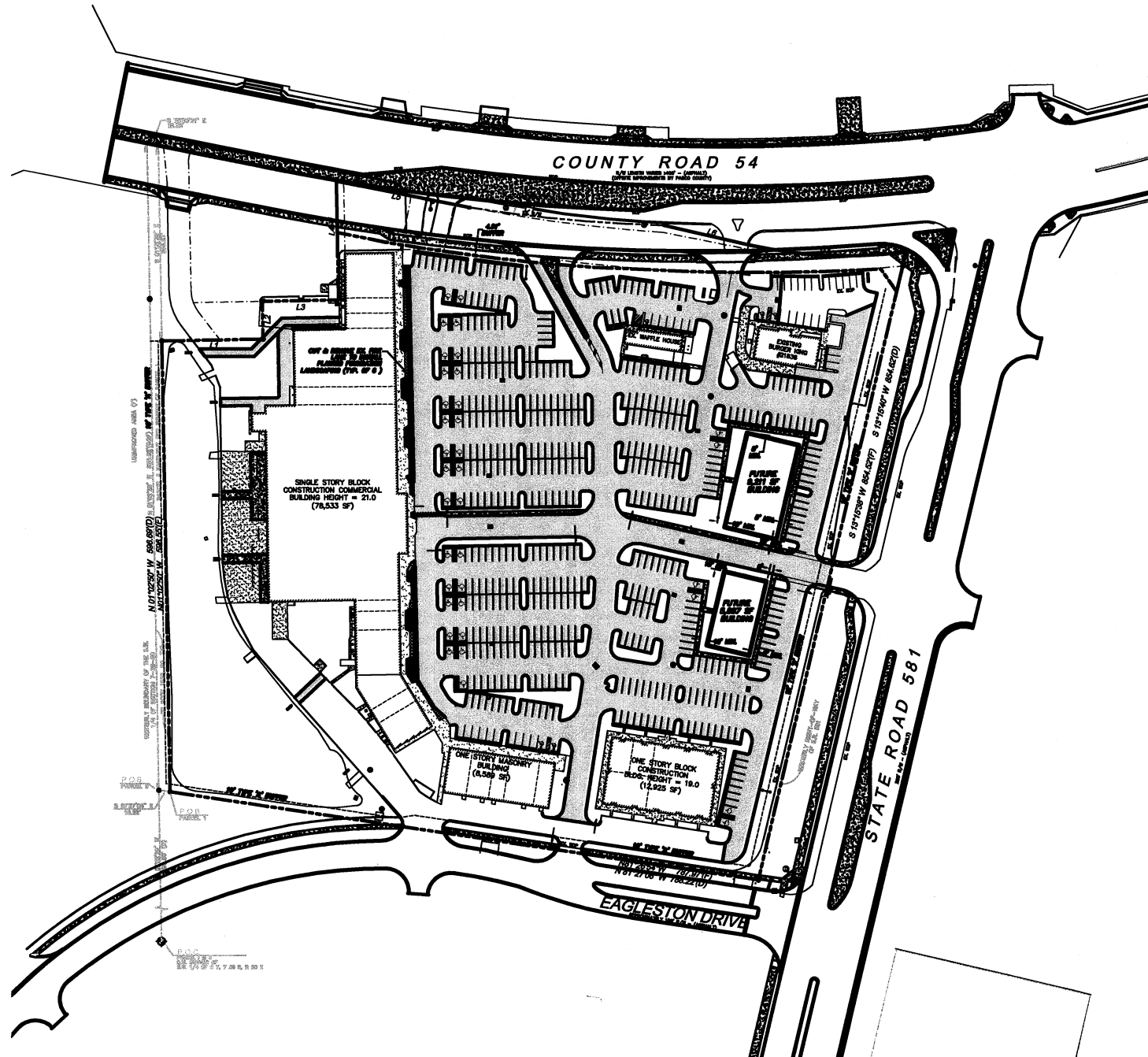

SCALE: 1" = 200'

PROJECT: VILLAGE MARKET - SITE IMPROVEMENTS 5351 STATE ROAD 581 PASCO		SHEET TITLE: VARIANCE PLAN (1 OF 2) WITHOUT APPROVAL
PREPARED FOR: RMCP PROPERTY GROUP		REGISTERED PROFESSIONAL ENGINEER CHRISTOPHER S. MORGAN, P.E. STATE LICENSE NO. 12824
MCNEAL ENGINEERING, INC. PO BOX 17121, TAMPA, FL 33662 PH: (813) 968-1081 FAX (813) 961-5839		
JOB NO. 09-010 ACAD FILE: SITEPLAN DRAWN BY: KCM CHECKED BY: CSM SCALE: 1" = 200' DATE: 08.12.02		SHEET NO. 1 of 2

THE FIGURES AND DIMENSIONS CONTAINED HEREON ARE THE COPYRIGHTED PROPERTY OF MCNEAL ENGINEERING, INC. CERTIFICATE OF AUTHORIZATION NUMBER: 081202-0001. ALL RIGHTS RESERVED. NO PART OF THIS DOCUMENT SHALL BE REPRODUCED OR TRANSMITTED IN ANY FORM OR BY ANY MEANS, ELECTRONIC OR MECHANICAL, WITHOUT WRITTEN CONSENT OF THE ENGINEER.

PARKING CALCULATIONS			
Description	SF	SF/Space	Required
Main - Retail	69,531	300	232
Main - Restaurant	10,050	100	101
SW - Office/Retail	7,328	300	24
SW - Restaurant	1,263	100	13
SE - Office/Retail	12,925	300	43
Waffle House - Restaurant	1,610	100	16
Burger King - Restaurant	3,533	100	35
Future Outparcel (N) - Future	9,211	100	92
Future Outparcel (S) - Future	5,867	100	59
Total	122,783		615

DESCRIPTION	WXD (FT)	RETAIL	
		REQUIRED	PROVIDED
Standard	9X20	593	580
Compact	8X18	0	0
Handicap	12X20	22	41
TOTAL	N/A	615	621

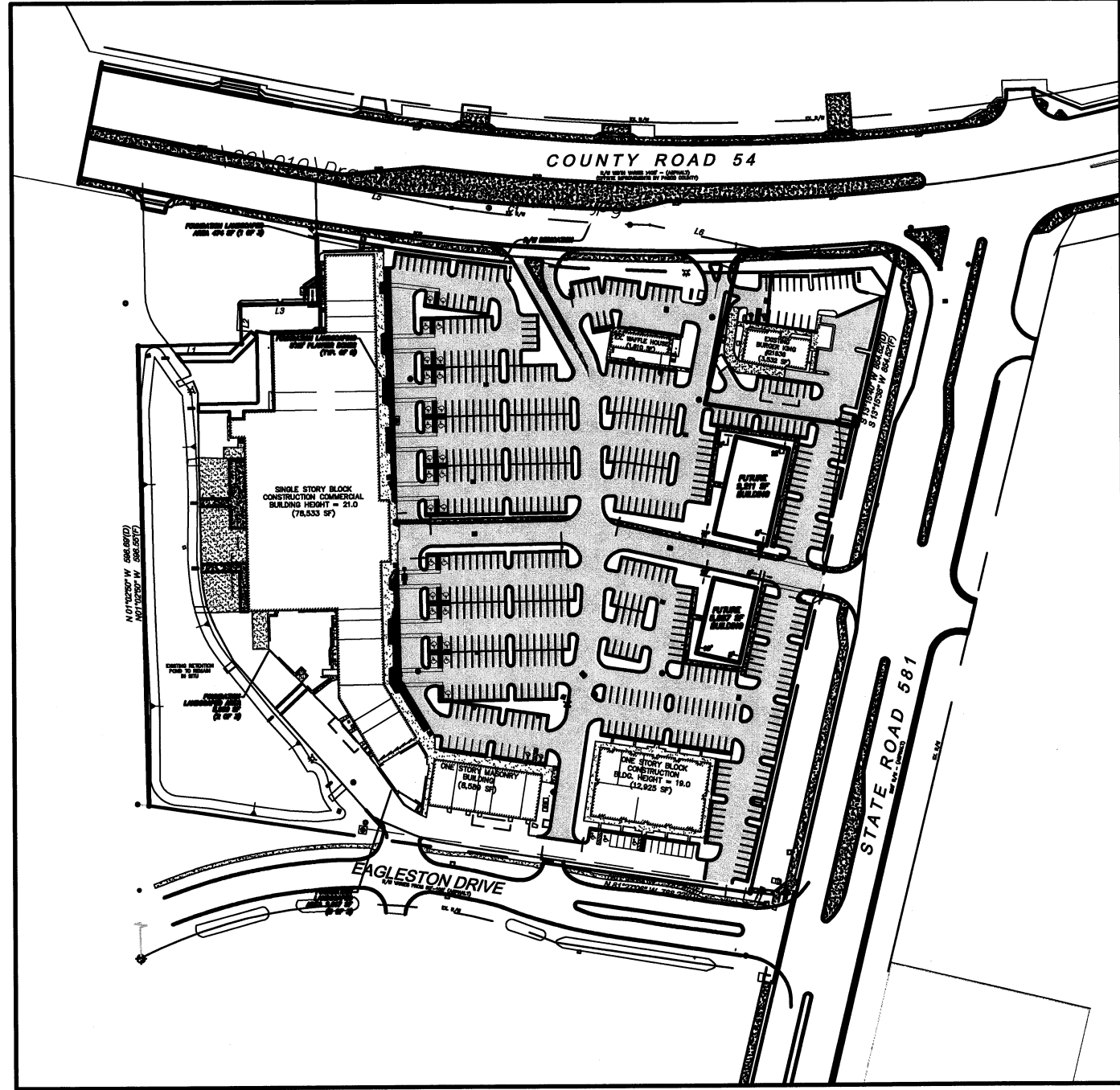

SCALE: 1" = 200'

PROJECT: VILLAGE MARKET - SITE IMPROVEMENTS
5351 STATE ROAD 581
PASCO

PREPARED FOR: RMC PROPERTY GROUP
SHEET TITLE: VARIANCE PLAN (2 OF 2)
WITH APPROVAL

McNEAL ENGINEERING, INC.
PO BOX 17121, TAMPA, FL 33662
PH. (813) 968-1081 FAX (813) 961-0639
SEAL

JOB NO. 09-010
ACAD FILE: SITEPLAN
DRAWN BY: KM
CHK'D BY: CSM
SCALE: 1" = 200'
DATE: 08.12.02
SHEET NO. 2 of 2

THE DESIGN AND DRAWINGS CONTAINED HEREIN ARE THE COPYRIGHTED PROPERTY OF McNEAL ENGINEERING, INC. CERTIFICATE OF AUTHORIZATION AND/OR SEAL SHALL NOT BE REPRODUCED WITHOUT WRITTEN CONSENT OF THE ENGINEER.