

River Landing

MPUD

Master Plan

Pasco County, Florida

Typical Lot Type and Size with Building Set Back Line

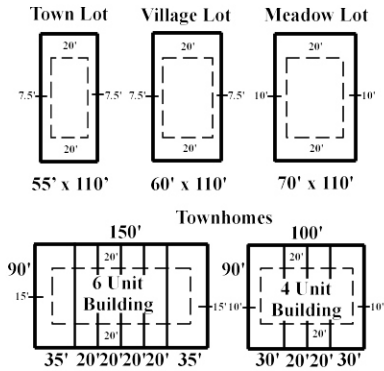

Legend

- Topography Contour Line
- Access
- Wetland Mitigation
- Wetland by Class
- Direction of Surface Drainage

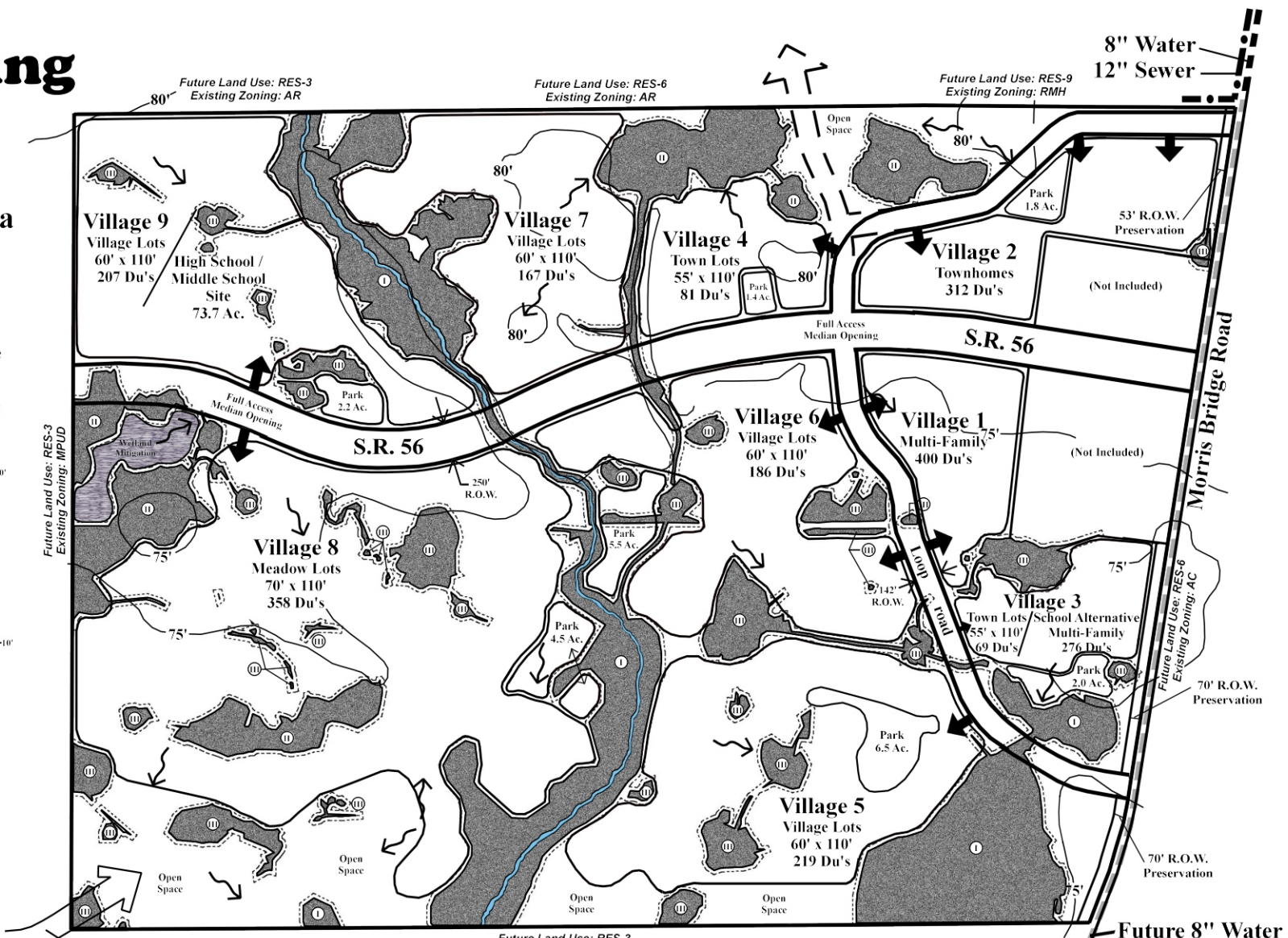

Future Land Use: RES-3
Existing Zoning: MPUD

Future Land Use: RES-3
Existing Zoning: AR

Future Land Use: RES-9
Existing Zoning: RMH

Future Land Use: RES-6
Existing Zoning: AC

POTENTIAL FUTURE CONNECTION TO LIVINGSTON MPUD (BY OTHERS)

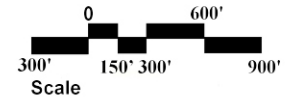

PREPARED FOR:
The Linville Family
c/o Zephyr Egg Company
P.O. Box 2679
Zephyrhills, Florida 33539-2679

PREPARED BY:
KING HELIE PLANNING GROUP, INC.
CITY PLANNERS & LAND DEVELOPMENT CONSULTANTS
P.O. BOX 5897
TALLAHASSEE, FLORIDA 32314
TELEPHONE: (771) 863-7606 FAX: (771) 863-7406